

Conduit Hangers

With Bolt & Nut Attached - Steel

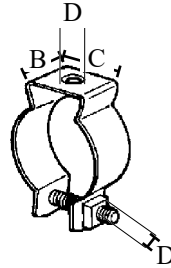

Features

- Assembled with nut and bolt

Applications

- Indoor or outdoor use
- Use to secure and suspend conduit from overhead supports

Standard Material

- Steel

Standard Finish

- Zinc plated

Catalog Number	UPC	Size	For Rigid	For EMT	Bolt Size	Ship Case	Weight/Case	A	B	C	D
601	15830	0	3/8" - 1/2"	1/2"	1/4" - 20	100	6	1.875	.75	.725	.25
602	15840	1	3/4"	3/4"	1/4" - 20	100	8	2.125	.75	.85	.25
603	15850	2	1"	1"	1/4" - 20	100	8	2.437	.875	.975	.25
604	15860	3	1-1/4"	1-1/2"	1/4" - 20	100	10	2.75	.875	.975	.25
604A	15870	2-1/2	---	1-1/4"	1/4" - 20	100	10	2.875	.875	1.05	.25
605	15880	4	1-1/2"	---	1/4" - 20	100	18	3.125	1	1.125	.25
606	15890	5	2"	2"	1/4" - 20	50	10	3.875	1	1.145	.25
607	15900	6	2-1/2"	2-1/2"	5/16" - 18	50	11	4.625	1.25	1.225	.3125
608	15910	7	3"	3"	5/16" - 18	25	6	5.50	1.25	1.275	.3125
609	15920	8	3-1/2"	3-1/2"	5/16" - 18	25	8	5.75	1.25	1.275	.3125
610	15930	9	4"	4"	5/16" - 18	25	12	6.25	1.25	1.275	.3125

Without Bolt & Nut Attached - Steel

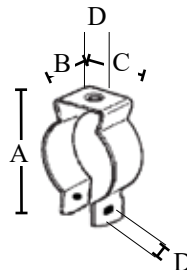

Features

- Eliminates need for fasteners

Applications

- Indoor or outdoor use
- Use to secure and suspend conduit from overhead supports

Standard Material

- Steel

Standard Finish

- Zinc plated

Catalog Number	UPC	Size	For Rigid	For EMT	Ship Case	Weight/Case	A	B	C	D
611	15940	0	3/8" - 1/2"	1/2"	100	5	1.875	.75	.725	.25
612	15950	1	3/4"	3/4"	100	7	2.125	.75	.85	.25
613	15960	2	1"	1"	100	7	2.437	.875	.975	.25
614	15970	3	1-1/4"	1-1/2"	100	9	2.75	.875	.975	.25
614A	15980	2-1/2	---	1-1/4"	100	9	2.875	.875	1.05	.25
615	15990	4	1-1/2"	---	100	17	3.125	1	1.125	.25
616	16000	5	2"	2"	50	9	3.875	1	1.145	.25
617	16010	6	2-1/2"	2-1/2"	50	11	4.625	1.25	1.225	.3125
618	16020	7	3"	3"	25	5	5.50	1.25	1.275	.3125
619	16030	8	3-1/2"	3-1/2"	25	7	5.75	1.25	1.275	.3125
620	16040	9	4"	4"	25	11	6.25	1.25	1.275	.3125